

## ● Quick Start

Remove the Port Compartment door (back, left side). Remove both the USB stick followed by the AC Adapter. Insert them into the ports as indicated.

### Insert Ports

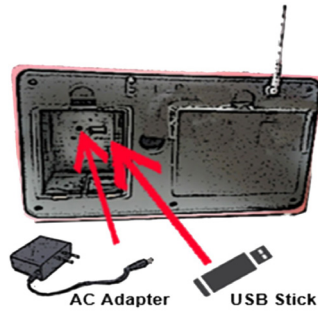

Insert AC plug into an outlet.

### Plug In



Turn on by pressing down the On/Off silver button.

### Turn On

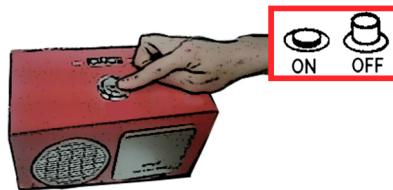

Switch between RADIO and MUSIC.

### Radio or Music (MP3)

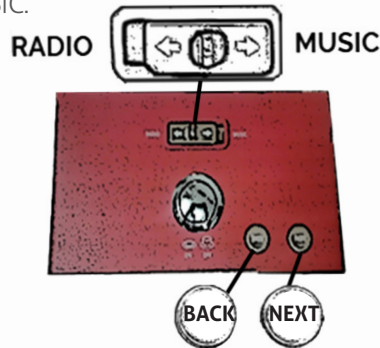

## ● Hidden Controls

Behind the removable front panel you can set the volume and store AM or FM radio stations. Purposely the controls are hidden from the user.

### Easy to Remove

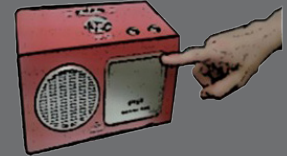

### Easy User Controls

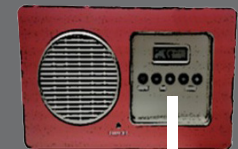

## ● Music Mode

1. Switch to MUSIC. Hear songs in MP3 format included on the USB stick.
2. Adjust volume to the users desired level. There are 10 volume levels. The Music volume level may be different than the Radio volume.
3. The USB stick is pre-loaded with 75 American Classics from the 20th Century. For better user enjoyment, add or delete songs most familiar to the user. 20-40 songs may be sufficient, however, download as many as 1,000 songs /audio books if desired.
4. Press NEXT button to skip to the next song, or BACK for the previous song. Songs always play in the same order, which is preferred by care recipients.
5. Only MP3 file format is supported. Convert other file formats, such as M4A, to MP3. For directions to convert file formats, go to the download section at: [www.simpltec.com/radio-music-player-details](http://www.simpltec.com/radio-music-player-details)
6. Only supports file system format FAT and FAT32. Does not support MacOS file system APFS/HFS+.
7. Only supports USB sticks with maximum capacity of 32GB.

## ● Radio Mode

Switch on Radio Mode. The last preset radio station you were listening to will start to play. The external antenna can improve reception of certain FM stations, but not AM. The AM antenna is inside the radio. To improve AM reception on certain channels, try moving the unit to another area of the room, rotate the unit or place closer to a window.

## ● Storing Radio Stations

1. Obtain a list of up to 10 preferred AM and/or FM radio stations from the user. You can store one or two stations, or as many as ten.
2. Remove the front panel and find the first station you want to store, selecting AM or FM and then TUNE -/+.
3. To store this station, press and hold the NEXT button located on top of the unit for about 3 seconds . The first station set will be S 1 (**Station 1**), show on display as:  Repeat step 2-3 to store more stations, up to S 10 (**Station 10**.)
4. Press the VOLUME -/+ buttons to the desired radio level. (*See Hidden Controls section on page 1*)
5. The BACK and NEXT buttons will cycle through stored channels only.

## ● Technical Specifications

Ac Power Adapter:	9VAC 1000 mA : Exclusively for this product. Do not plug in with other adapters
Power:	AC 120 volts AC/AC adaptor in Portable: Insert 6 x C-size batteries for portability
User Controls:	ON/OFF, RADIO/MUSIC, BACK/NEXT
Hidden Controls:	AM/FM, TUNE (-/+) & VOLUME (-/+)
Radio Station Storage Memory:	Up to 10 stations
Headphone:	Insert jack into port in front of unit.
Power Consumption:	300 mA ~ 1A at 9V
Amplifier:	6W Class D mono audio player AM/FM radio with antenna
Dimensions:	10" w x 6 1/8" h x 5 3/4" d, 4 lb (26 x 16 x 15 cm, 1.8 KG )

## ● Technical Support

**TECHNICAL SUPPORT or WARRANTY SERVICE, DO NOT RETURN THE UNIT TO RESELLER, CONTACT US, THE MANUFACTURER FIRST:**

Please call 1-833-237-4675 Ex.1 or Email [support@simpltec.com](mailto:support@simpltec.com) or visit [www.simpltec.com/radio-music-player](http://www.simpltec.com/radio-music-player) for Q & A.

USA: SMPL TECHNOLOGY, 340 Royal Poinciana Way, Suite 317,  
Palm Beach, Florida 33480

Canada: 3-100 Hanlan Road, Woodbridge, Ontario L4L 4V8

## ● Warranty Specifications

### WARRANTY:

Simpl Technology LLC warrants the SMPL Radio & Music Player (to be free of defects in material and workmanship) for twelve (12) months from the date of purchase. Within the warranty period, the warranty is limited to the repair or replacement of defective parts only at the discretion of Manufacturer.

The warranty may be void if the Music Player is damaged or destroyed as a result of one or more of the following willful abuse or neglect; modification of the unit; using alternative power supplies to that provided; using of organic solvents, strong acids or petroleum-based solvent / ammonia.

### SAFETY INSTRUCTIONS:

The device shall not be exposed to dripping or splashing or near a bathtub. The device should be situated away from heat sources such as radiators. Heat registers, stoves or other appliance (including amplifiers) that produce heat. The power supply cords should not be routed so that they are not likely to be walked on or pinched by items placed upon or against them or chewed by pets. To avoid the risk of electric shock, do not remove the cover of the apparatus. There are no user serviceable parts inside. Do not operate this product if the main lead is damaged.

### COMPLIANCE:

Operation is subject to the following three conditions: 1) This device may not cause harmful interference. 2) This device must accept any interference received, including interference that may cause undesired operation. Changes or modifications to the electronics in the device by an unauthorized dealer or technician will void the warranty.

### WARNING:

This product contains chemicals known to the State of California to cause cancer and birth defects or other reproductive harm.

